



SPORT
TRAINER

450M

OPERATING GUIDE

PLEASE READ THIS ENTIRE GUIDE BEFORE BEGINNING

Hereinafter Radio Systems Corporation, Radio Systems PetSafe Europe Ltd., Radio Systems Australia Pty Ltd. and any other affiliate or Brand of Radio Systems Corporation may be referred to collectively as "We" or "Us".

IMPORTANT SAFETY INFORMATION

EXPLANATION OF ATTENTION WORDS AND SYMBOLS USED IN THIS GUIDE



This is the safety alert symbol. It is used to alert you to potential personal injury hazards. Obey all safety messages that follow this symbol to avoid possible injury or death.



WARNING indicates a hazardous situation which, if not avoided, could result in death or serious injury.



CAUTION, used without the safety alert symbol, indicates a hazardous situation which, if not avoided, could result in harm to your dog.

⚠️ WARNING

- Not for use with aggressive dogs. Do not use this product if your dog is aggressive or if your dog is prone to aggressive behaviour. Aggressive dogs can cause severe injury and even death to their owner and others. If you are unsure whether this product is appropriate for your dog, please consult your veterinarian or a certified trainer.
- This device contains Lithium-Ion (Li-Ion) batteries; never incinerate, puncture, deform, short-circuit, or charge with an inappropriate charger. Fire, explosion, property damage, or bodily harm may occur if this warning is not followed.
- Risk of explosion if battery is replaced by an incorrect type. Dispose of spent batteries according to the regulations in your area.
- Batteries should never be removed from the battery compartment for charging.
- Risk of explosion if batteries are charged in areas with high temperature (38° C / 100° F+).

CAUTION

Please read and follow the instructions in this manual. Proper fit of the collar is important. A collar worn for too long or made too tight on the dog's neck may cause skin damage. This is called bed sores; it is also called decubitus ulcers or pressure necrosis.

- Avoid leaving the collar on the dog for more than 12 hours per day.
- When possible, reposition the collar on the dog's neck every 1 to 2 hours.
- Check the fit to prevent excessive pressure; follow the instructions in this manual.
- Never connect a lead to the Collar Receiver; it will cause excessive pressure on the contacts.
- When using a separate collar for a lead, don't put pressure on the electronic collar.
- Wash the dog's neck area and the contacts of the collar weekly with a damp cloth.
- Examine the contact area daily for signs of a rash or a sore.
- If a rash or sore is found, discontinue use of the collar until the skin has healed.
- If the condition persists beyond 48 hours, see your veterinarian. For additional information on bed sores and pressure necrosis, please visit our website at www.sportdog.com.

These steps will help keep your dog safe and comfortable. Millions of dogs are comfortable while they wear stainless steel contacts. Some dogs are sensitive to contact pressure. You may find after some time that your dog is very tolerant of the collar. If so, you may relax some of these precautions. It is important to continue daily checks of the contact area. If redness or sores are found, discontinue use until the skin has fully healed.

- You may need to trim the hair in the area of the Contact Points or switch to the longer Contact Points to ensure consistent contact. Never shave the dog's neck; this may lead to a rash or infection.
- You should not make the collar any tighter than is required for good contact. A collar that is too tight will increase the risk of pressure necrosis in the contact area.

Thank you for choosing SportDOG® Brand training products. Used properly, this product will help you train your dog efficiently and safely. To ensure your satisfaction, please review this Operating Guide thoroughly. If you have questions regarding this product's operation, please see this manual's Frequently Asked Questions and Troubleshooting sections or contact our Customer Care Centre. For a listing of telephone numbers in your area, visit our website at www.sportdog.com.

To get the most protection out of your warranty, please register your product within 30 days at www.sportdog.com. By registering and keeping your receipt you will enjoy the product's full warranty and, should you ever need to call the Customer Care Centre, we will be able to help you faster. Most importantly, your valuable information will never be given or sold to anyone. Complete warranty information is available online at www.sportdog.com.

TABLE OF CONTENTS

COMPONENTS	5
HOW THE SYSTEM WORKS	5
KEY DEFINITIONS	6
PREPARE THE REMOTE TRANSMITTER.....	7
PREPARE THE COLLAR RECEIVER	8
FIT THE COLLAR RECEIVER	10
FIND THE BEST INTENSITY LEVEL FOR YOUR DOG	11
GENERAL TRAINING TIPS.....	12
PROGRAM THE REMOTE TRANSMITTER	12
MATCH THE COLLAR RECEIVER AND REMOTE TRANSMITTER.....	14
PROGRAM THE SYSTEM FOR TWO OR THREE-DOG OPERATION	14
CHANGE ID CODES	15
ACCESSORIES	15
FREQUENTLY ASKED QUESTIONS	16
TROUBLESHOOTING.....	17
TEST LIGHT TOOL INSTRUCTIONS.....	17
TERMS OF USE AND LIMITATION OF LIABILITY	18
COMPLIANCE	18
BATTERY DISPOSAL.....	19
IMPORTANT RECYCLING ADVICE	19
WARRANTY	20

TRAINING GUIDE

Please visit our website at www.sportdog.com to download a detailed Training Guide for this unit or contact our Customer Care Centre for further assistance. For a listing of telephone numbers in your area, visit our website at www.sportdog.com.

COMPONENTS



HOW THE SYSTEM WORKS

The SportDOG® SportTrainer® SD-425CAMO-E Remote Trainer has been proven safe, comfortable, and effective for all dogs over 3.6 kg. Consistent, correct use of this product allows you to reinforce commands and correct misbehaviour from up to 450 metres. The Remote Transmitter sends a signal, activating the Collar Receiver to deliver a harmless stimulation. With proper training, a dog will learn to associate this signal with a command. Like all SportDOG® products, this model features adjustable static stimulation levels so you can tailor the stimulation level to your dog's temperament, eliminating the risk of over-stimulation.

IMPORTANT: THE SPORTTRAINER® SD-425CAMO-E REMOTE TRAINER HAS A RANGE OF UP TO 450 M. DEPENDING ON THE WAY YOU HOLD THE REMOTE TRANSMITTER, THE MAXIMUM RANGE MAY VARY. FOR CONSISTENT RESULTS AT LONGER RANGES, HOLD THE REMOTE TRANSMITTER IN A VERTICAL POSITION AWAY FROM YOUR BODY AND ABOVE YOUR HEAD. TERRAIN, WEATHER, VEGETATION, TRANSMISSION FROM OTHER RADIO DEVICES, AND OTHER FACTORS WILL AFFECT THE MAXIMUM RANGE.



⚠ WARNING

Do not use this product if your dog is aggressive or if your dog is prone to aggressive behaviour. Aggressive dogs can cause severe injury and even death to their owner and others. If you are unsure whether this product is appropriate for your dog, please consult your veterinarian or a certified trainer.

KEY DEFINITIONS

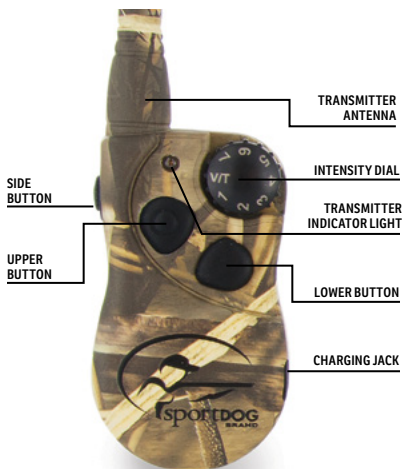

REMOTE TRANSMITTER: Transmits the radio signal to the Collar Receiver. It is waterproof and can be submerged in water to a depth of 7.6 m.

INTENSITY DIAL: Provides multiple levels and types of stimulation so you can match the stimulation to your dog's temperament.

TRANSMITTER INDICATOR LIGHT: Indicates that a button is pressed and also serves as a low-battery indicator.

UPPER BUTTON: This button is factory-set to deliver continuous static stimulation.

LOWER BUTTON: This button is factory-set to deliver momentary static stimulation, or a "Nick".

SIDE BUTTON: This button is factory-set to deliver a tone without static stimulation.

CHARGING JACK: For connecting the charger. Although the Remote Transmitter is waterproof without it, keep the cover in place when not charging to keep debris out of the opening.

MODE BUTTON: This button gives you the ability to change the mode of your Remote Transmitter.

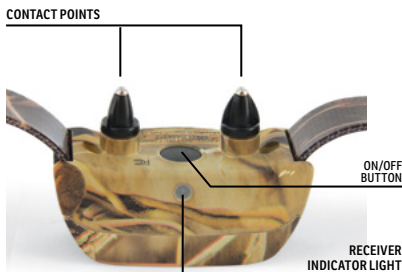

COLLAR RECEIVER: Receives the radio signal from the Remote Transmitter and delivers the static, vibration, or tone stimulation for correcting or cueing your dog. It is waterproof and can be submerged in water to a depth of 7.6 m.

RECEIVER INDICATOR LIGHT: Indicates when the Collar Receiver has been turned on or off, serves as a low-battery indicator, and also indicates when a continuous or momentary (nick) static stimulation button is pressed.

CONTACT POINTS: The contacts through which the Collar Receiver delivers static stimulation.

ON/OFF BUTTON: Momentarily pressing and releasing this button turns the Collar Receiver on and off.

THE COLLAR RECEIVER IS CAPABLE OF DELIVERING FOUR TYPES OF STIMULATION:

CONTINUOUS: You control both when and how long static stimulation is delivered, up to a maximum of 10 seconds. After 10 seconds, the Remote Transmitter will "time out" and static stimulation cannot be delivered to your dog for 5 seconds. After the 5 second "time-out" period, static stimulation can be delivered again.

MOMENTARY (NICK): Static stimulation is delivered for 1/10 of a second, regardless of how long the button is pressed.

TONE: The Collar Receiver will make a rapid beeping noise when a Tone button is pressed.

VIBRATION (VIBE): The Collar Receiver will vibrate when a Vibration button is pressed, up to a maximum of 10 seconds. After 10 seconds, the Remote Transmitter will "time out" and vibration stimulation cannot be delivered to your dog for 5 seconds. After the 5 second "time-out" period, vibration stimulation can be delivered again.

STEP :: 01

PREPARE THE REMOTE TRANSMITTER

CHARGE THE REMOTE TRANSMITTER

1. Lift the rubber cover protecting the Charging Jack.
2. Connect one of the charger connectors to the Charging Jack.
3. Plug the charger into a standard wall outlet.
4. Charge the Remote Transmitter for 2 hours for the first charge and every charge thereafter.

Using Lithium-Ion technology, the Remote Transmitter only requires a 2 hour charge. It is not harmful to let the unit charge for more than 2 hours.

5. When charging is complete, replace the rubber cover.

Note: Approximate battery life between charges is 50 to 70 hours, depending on frequency of use.



TRANSMITTER INDICATOR LIGHT

OPERATIONAL MODE	LIGHT COLOUR	BATTERY STATUS	LIGHT FUNCTION
Continuous static tone, or vibration stimulation pressed	Green	Good	Light is solid in colour while button is pressed
Continuous static, tone, or vibration stimulation pressed	Red	Low	Light is solid in colour while button is pressed
Momentary static stimulation button pressed	Green	Good	Light flashes once and turns off
Momentary static stimulation button pressed	Red	Low	Light flashes once and turns off
Unit is charging	Green	Low	Light is solid in colour while charging
Unit is fully charged (charger still connected)	Green	Good	Light flashes once per second once the battery is completely charged

STEP :: 02

PREPARE THE COLLAR RECEIVER

CHARGE THE COLLAR RECEIVER

1. Lift the rubber cover protecting the Charging Jack.
2. Connect one of the charger connectors to the Charging Jack.
3. Plug the charger into a standard wall outlet.
4. Charge the Collar Receiver for 2 hours for the first charge and every charge thereafter.

Using Lithium-Ion technology, the Collar Receiver only requires a 2 hour charge. It is not harmful to let the unit charge for more than 2 hours.

5. When charging is complete, replace the rubber cover.

TO TURN THE COLLAR RECEIVER ON

Press and release the On/Off Button. The Receiver Indicator Light will come on and the Collar Receiver will beep 2-3 times depending on what static stimulation range is chosen. The default is 3 (high).

TO TURN THE COLLAR RECEIVER OFF

Press and release the On/Off Button. The Receiver Indicator Light comes on solid (red) and the Collar Receiver beeps continuously for 2 seconds.

To extend the life between charging cycles, turn the Collar Receiver off when it is not in use.

NOTE: Approximate battery life between charges is 50 to 70 hours, depending on frequency of use.

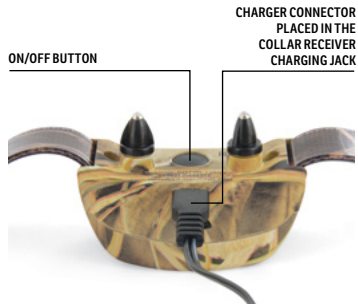

RECEIVER INDICATOR LIGHT

OPERATIONAL MODE	LIGHT COLOUR	BATTERY STATUS	LIGHT FUNCTION	SPEAKER FUNCTION	VIBRATION
Unit is turned on via On/Off Button	Green	Good	Light is solid in colour during beep sequence	Beeps 2-3 times depending on static stimulation range setting (3 is the default). Please see page 11.	N/A
Unit is turned on via On/Off Button	Red	Low	Light is solid in colour during beep sequence		
Unit is turned off via On/Off Button	Red	N/A	Light is solid in colour during beep sequence	Beeps continuously for 2 seconds	N/A
Unit is on	Green	Good	Light flashes every 2 seconds	N/A	N/A
Unit is on	Red	Low	Light flashes every 2 seconds	N/A	N/A
Unit is delivering continuous static stimulation	Red	N/A	Light is solid in colour for as long as button is pressed (up to 10 seconds)	N/A	N/A
Unit is delivering momentary (nick) static stimulation	Red	N/A	Light will quickly flash once no matter how long button is pressed	N/A	N/A
Unit is delivering tone stimulation	Off	N/A	N/A	Unit will beep for as long as button is pressed	N/A
Unit is delivering vibration stimulation	Off	N/A	N/A	N/A	Unit will vibrate for as long as button is pressed (up to 10 seconds)
Unit is charging	Green	Low	Light is solid in colour while charging	N/A	N/A
Unit is fully charged (charger still connected)	Green	Good	Light flashes once per second once the battery is completely charged	N/A	N/A

RECHARGEABLE BATTERIES

⚠ WARNING

- This device contains Lithium-Ion (Li-Ion) batteries; never incinerate, puncture, deform, short-circuit, or charge with an inappropriate charger. Fire, explosion, property damage, or bodily harm may occur if this warning is not followed.
- Risk of explosion if battery is replaced by an incorrect type. Dispose of spent batteries according to the regulations in your area.
- Batteries should never be removed from the battery compartment for charging.
- Risk of explosion if batteries are charged in areas with high temperature (38° C / 100° F+).
- The rechargeable Lithium Ion (Li-Ion) batteries are not memory sensitive, do not require depletion before charging, and cannot be over charged.
- The batteries come partially charged from the factory, but will require a full charge before the first use.
- **When storing the unit for long periods, remember to regularly give batteries a full charge. This should be done once every 3 to 4 months.**
- You should expect hundreds of recharge cycles from your batteries. However, all rechargeable batteries lose capacity over time relative to the number of recharge cycles they experience. This is normal. If your operating time drops to half of the original life, contact the Customer Care Centre to purchase a new battery.
- The batteries should last for a period of 3-5 years. When a battery needs replacement, you can order a new pack by calling our Customer Care Centre. For a listing of telephone numbers in your area, visit our website at www.sportdog.com. Please do not open the Collar Receiver or Remote Transmitter until you have received the replacement.

STEP :: 03

FIT THE COLLAR RECEIVER

IMPORTANT: The proper fit and placement of the Collar Receiver is important for effective training. The Contact Points must have direct contact with your dog's skin.

CAUTION

Please see page 3 for Important Safety Information.

To ensure a proper fit, follow these steps:

1. With your dog standing (**3A**), center the Collar Receiver so the Contact Points are underneath your dog's neck, touching the skin (**3B**). If your dog has a long or thick coat, you have two options to ensure consistent contact: either trim the hair around the Contact Points or switch to the longer Contact Points included with your system.

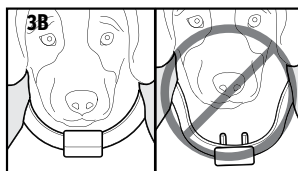
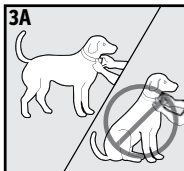

CAUTION

- You may need to trim the hair in the area of the Contact Points. Never shave the dog's neck; this may lead to a rash or infection.
 - You should not make the collar any tighter than is required for good contact. A collar that is too tight will increase the risk of pressure necrosis in the contact area.
2. The Collar Receiver should fit snugly, yet loose enough to allow one finger to fit between the strap and your dog's neck (**3C**).
 3. Allow your dog to wear the collar for several minutes, and then recheck the fit. Check the fit again as your dog becomes more comfortable wearing the Collar Receiver.

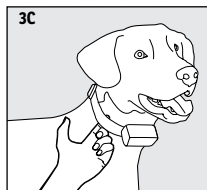

STEP :: 04

FIND THE BEST INTENSITY LEVEL FOR YOUR DOG

The SportTrainer® SD-425CAMO-E Remote Trainer has multiple intensity levels. This allows you to choose the static stimulation that is best for your dog.

NOTE: Always start at the lowest level and work your way up.

For training efficiency, it is important to find the right intensity level for your dog. This is called the "Recognition Level", and is the level at which your dog looks around in curiosity or flicks his ears.

TO FIND YOUR DOG'S RECOGNITION LEVEL

NOTE: Every dog is different and you cannot predict where your dog's Recognition Level will be. Watch closely for any slight change in behaviour that demonstrates your dog is feeling the static stimulation.

1. With the Collar Receiver turned on and properly fitted to your dog, set the Remote Transmitter's Intensity Dial at Level 1 and press the Continuous Static Stimulation Button for 1 to 2 seconds.
2. If your dog shows no reaction to Level 1, go to Level 2 and repeat the process.
3. **YOUR DOG SHOULD NOT VOCALIZE OR PANIC WHEN RECEIVING STATIC STIMULATION. IF THIS HAPPENS, THE STATIC STIMULATION LEVEL IS TOO HIGH AND YOU NEED TO GO BACK TO THE PREVIOUS LEVEL AND REPEAT THE PROCESS.**
4. Once you find your dog's Recognition Level, this is the level you should use when you begin a training exercise.
5. If you have progressed to Level 7 while searching for your dog's Recognition Level and your dog continues to show no response, check to see if the Collar Receiver is snug against your dog's neck. Then go back to Intensity Level 1 and repeat the process. If your dog still does not indicate he is feeling the static stimulation, you have three options: trim the hair beneath the Contact Points, switch to the longer Contact Points included in your system, or change the static stimulation range.

If after completing all of these steps your dog still does not indicate he is feeling the static stimulation, please contact the Customer Care Centre.

CHANGE STATIC STIMULATION RANGES

The SportTrainer® SD-425CAMO-E Collar Receiver has 2 static stimulation ranges (**medium and high**). There are 7 static stimulation levels within each range, with 1 being the lowest and 7 being the highest. The default range setting is 3 (high).

To change the range of static stimulation, follow these steps:

1. Make sure the Collar Receiver is off.
2. Turn the unit on by pressing and releasing the On/Off Button.
3. Within 5 seconds of the indicator light turning off, press and hold the On/Off Button for 3 seconds.
4. The Collar Receiver will then beep twice and the Indicator Light will flash orange. This indicates **Medium** static stimulation range. If **High** is desired, continue to hold the On/Off Button until the number of beeps/orange flashes equals 3 as shown in the chart below.
5. Release the On/Off Button once the desired range is selected; the Collar Receiver will turn off.
6. Turn the unit back on. It will then beep according to the static stimulation range selected in Step 4.

	STATIC STIMULATION RANGE	DOG TEMPERAMENT
2 beeps	Medium	Moderate
3 beeps	High	Stubborn

GENERAL TRAINING TIPS

BEFORE TRAINING YOUR DOG WITH THIS PRODUCT

You will have the most success using this Remote Trainer if you always remember to teach a command before trying to reinforce the command with the Remote Trainer. Always keep the following training tips in mind:

- Eliminate one misbehaviour or teach one obedience command at a time. If you move too fast with the training, your dog may become confused.
- Be consistent. Give your dog a static, tone, or vibration stimulation with each misbehaviour.
- Do not overcorrect your dog. Use as few stimulations as possible to train your dog.
- Restrict your dog from situations in which he has a history of misbehaving unless you can supervise him and use the Remote Trainer for applying static, tone, or vibration stimulation.
- If you notice one situation in which your dog misbehaves repeatedly, set up this situation as a training session. This will dramatically increase your chances of success.
- If your dog has a timid reaction to the static, tone, or vibration stimulation (especially the first couple of times), do not be alarmed. Redirect his attention to a simple and appropriate behaviour (i.e. a known command, such as "Sit").
- Never use the Remote Trainer to correct or eliminate any form of aggressive behaviour. If your dog exhibits such behaviour, contact a professional trainer. Aggression in dogs is the result of many factors. It may be a learned behaviour or it may be brought on as a result of fear. Another factor contributing to aggression in dogs is social dominance. Every dog is different.

Visit our website at www.sportdog.com to find more detailed training tips and guides or contact our Customer Care Centre for further assistance. For a listing of the phone numbers in your area, visit our website at www.sportsdog.com.

At this point, your Remote Trainer is ready to use. The Remote Transmitter is factory set to mode 1, but you may wish to change the mode to fit your situation. See STEP 05 for an explanation of mode options.

STEP :: 05

PROGRAM THE REMOTE TRANSMITTER

The SportTrainer® SD-425CAMO-E Remote Transmitter has seven operational modes to allow you to select the best match for your type or style of training. The Remote Transmitter is factory set to mode 1. There is also one programming mode: Mode V/T (Change ID Codes).

TO CHANGE THE MODE

1. Referring to the following table, adjust the Intensity Dial to your desired mode.
2. Turn the Remote Transmitter over.
3. Using a pen or the tine on the buckle of your collar strap, press and release the Mode Button. When the Mode Button is pressed, the Transmitter Indicator Light will be solid in colour. When it is released, it will flash the number of times for the mode selected.

For example, if mode 5 is desired, adjust the Intensity Dial to Level 5. Once the Mode Button has been depressed, the Transmitter Indicator Light will be solid and, once the mode button is released, the Transmitter Indicator Light will flash 5 times.



MODE	UPPER BUTTON FUNCTION	LOWER BUTTON FUNCTION	SIDE BUTTON FUNCTION	NUMBER OF DOGS
1*	Continuous static stimulation (Level set by Intensity Dial) OR Vibration stimulation if V/T on Dial	Momentary static stimulation (Level set by Intensity Dial) OR Vibration stimulation if V/T on Dial	Tone stimulation only	1
2	Continuous static stimulation (Level set by Intensity Dial) OR Tone stimulation if V/T on Dial	Momentary static stimulation (Level set by Intensity Dial) OR Tone stimulation if V/T on Dial	Vibration stimulation only	1
3	Dog 1: Continuous static stimulation (Level set by Intensity Dial) OR Tone stimulation if V/T on Dial	Dog 2: Continuous static stimulation (Level set by Intensity Dial) OR Tone stimulation if V/T on Dial	Dog 3: Continuous static stimulation (Level set by Intensity Dial) OR Tone stimulation if V/T on Dial	3
4	Dog 1: Continuous static stimulation (Level set by Intensity Dial) OR Vibration stimulation if V/T on Dial	Dog 2: Continuous static stimulation (Level set by Intensity Dial) OR Vibration stimulation if V/T on Dial	Dog 3: Continuous static stimulation (Level set by Intensity Dial) OR Vibration stimulation if V/T on Dial	3
5	Continuous static stimulation (Level set by Intensity Dial) OR Tone stimulation if V/T on Dial	Momentary static stimulation (Level set by Intensity Dial) OR Tone stimulation if V/T on Dial	N/A	1
6	Continuous static stimulation (Level set by Intensity Dial) OR Vibration stimulation if V/T on Dial	Momentary static stimulation (Level set by Intensity Dial) OR Vibration stimulation if V/T on Dial	N/A	1
7	Continuous static stimulation (Level set by Intensity Dial) OR Tone stimulation if V/T on Dial	Momentary static stimulation (Level set by Intensity Dial) OR Tone stimulation if V/T on Dial	Locate Remote Beeper**	1
V/T (ID CODE)	N/A	N/A	See STEP 08	N/A

* Factory Default Mode

** Locate Remote Beeper: The Side Button turns Run Mode off and locates the Remote Beeper. To enable Run Mode again, press and hold the Side Button for 3 seconds.

STEP :: 06

MATCH THE COLLAR RECEIVER AND REMOTE TRANSMITTER

To match the Collar Receiver to work with a new Remote Transmitter or to match a new Collar Receiver to work with your existing Remote Transmitter:

1. Turn the Collar Receiver off.
2. Press and hold the On/Off Button. The Receiver Indicator Light will come on, then turn off after 4-5 seconds. If the On/Off Button is released too early, the Receiver Indicator Light will begin flashing as normal. If this occurs, start over from 1.
3. After the Receiver Indicator Light has turned off, release the On/Off Button.
4. Press and hold the Upper Button on the Remote Transmitter until the Receiver Indicator Light flashes 5 times. Once the Receiver Indicator Light has flashed 5 times, the Collar Receiver has been matched and will begin flashing as normal. If the Receiver Indicator Light does not flash 5 times, start over from 1.

STEP :: 07

PROGRAM THE SYSTEM FOR TWO OR THREE-DOG OPERATION

SportDOG® Add-A-Dog™ extra Collar Receiver(s) must be purchased to train additional dogs. **Please refer to the last page for compatible Add-A-Dog™ extra Collar Receivers for this system.**

1. Program the Remote Transmitter to mode 3 or 4 (see STEP 05).
2. Program the first Collar Receiver.
 - A. Turn the Collar Receiver off.
 - B. Press and hold the On/Off Button. The Receiver Indicator Light will come on, then turn off after 4-5 seconds. If the On/Off Button is released too early, the Receiver Indicator Light will begin its normal flashing. If this occurs, start over from A.
 - C. After the Receiver Indicator Light has turned off, release the On/Off Button.
 - D. Press and hold the Upper Button on the Remote Transmitter until the Receiver Indicator Light flashes 5 times. If the Receiver Indicator Light does not flash 5 times, start over from A.
3. Program the second Collar Receiver using A through D above, but using the Lower Button in place of the Upper Button.
4. Program the third Collar Receiver using A through D above, but using the Side Button in place of the Upper Button.

STEP :: 08

CHANGE ID CODES

An ID Code is the signal identification between the Remote Transmitter and Collar Receiver. Each is programmed in 1 of 2,000 ID Codes from the factory. The SportTrainer® SD-425CAMO-E has the flexibility to program two or more Remote Transmitters to the same ID Code, allowing them to both control one Collar Receiver. There are 64 programmable ID Codes available.

TO MANUALLY PROGRAM A REMOTE TRANSMITTER'S ID CODE

1. Turn the Intensity Dial to V/T and then press and release the Mode Button on the back of your Remote Transmitter. This does not change the mode, so the current mode will still be active after the ID change is complete.
2. Once the Mode Button is released, the Transmitter Indicator Light will illuminate solid green and stay on for 15 seconds.
3. While the green Indicator Light is on, turn the Intensity Dial to select the 1st digit of the ID and then press and release the Side Button. The green Indicator Light will flash rapidly confirming selection.
4. Again, while the green Indicator Light is on, turn the Intensity Dial to select the 2nd digit of the ID and then press and release the Side Button. The green Indicator Light will flash rapidly confirming selection. The 2nd digit is optional and, if not desired, wait until the green light turns off and refrain from pressing the Side Button.
5. At the end of 15 seconds, or after the second press of the Side Button, the green Indicator Light will turn off and the ID of the Remote Transmitter will be updated. At this point, the Remote Transmitter will be in the same mode it was in prior to setting the ID.
6. Upon changing the ID Code, you will need to match the Collar Receiver to the Remote Transmitter (see STEP 06).

TO RETURN THE REMOTE TRANSMITTER TO THE FACTORY ID

1. Turn the Intensity Dial to V/T and then press and release the Mode Button on the back of your Remote Transmitter. This does not change the mode, so the current mode will still be active after the ID change is complete.
2. Do not press any buttons and wait until the green Transmitter Indicator Light turns off.
3. You will need to match the Collar Receiver to the Remote Transmitter (see STEP 06).

NOTE: Removing the battery will also return the Remote Transmitter to the factory ID.

ACCESSORIES

To purchase additional accessories for your SportDOG® SportTrainer® SD-425CAMO-E Remote Trainer, contact the Customer Care Centre or visit our website at www.sportdog.com to locate a retailer near you.

FREQUENTLY ASKED QUESTIONS	
Is the static stimulation safe for my dog?	While Continuous static and/or Momentary static stimulation may be unpleasant, it is harmless to your dog. Electronic training devices require interaction and training from the owner to achieve desired results.
How old does a dog have to be before using the Remote Trainer?	Your dog should be able to learn basic obedience commands such as "Sit" or "Stay". The system should only be used with dogs over 6 months of age. The Collar Receiver may be too large for dogs under 3.6 kg. If your pet is injured or its mobility is otherwise impaired, contact your veterinarian or professional trainer before use.
Once my dog is trained and has been obeying my commands, will my dog have to continue to wear the Collar Receiver?	Your dog may need to wear the Collar Receiver from time to time for reinforcement. Also, many hunters keep the Collar Receiver on their dogs while hunting for maximum control.
Is the Collar Receiver waterproof?	Yes. If the rechargeable battery pack ever needs to be replaced, make sure the o-ring and o-ring groove are free from dirt and debris.
Can my Collar Receiver be used around salt water?	Yes. However, if the Collar Receiver is used in or around salt water, it should be rinsed with fresh water following each use.
Can I use the Remote Trainer with more than one dog?	Yes. The SportTrainer® SD-425CAMO-E Remote Trainer is expandable to a maximum of 3 dogs. SportDOG® Add-A-Dog™ Collar Receivers must be purchased. Please refer to the Last page for a list of compatible Collar Receivers.
Can I use the Remote Trainer on aggressive dogs?	We do not recommend any of our products to be used on aggressive dogs. We recommend you contact your local veterinarian or professional trainer to determine if your dog might be aggressive.
Will I get exactly 450 m of range with the Remote Trainer?	The range you get with your Remote Trainer will vary according to terrain, weather, and vegetation as well as transmission from other radio devices. To get the maximum amount of range, please refer to "How the System Works" section of this guide.
How long can I continuously deliver stimulation to my dog?	The maximum amount of time you can press the Continuous Static Stimulation Button and deliver static stimulation to your dog continuously is 10 seconds. The maximum amount of time you can press the vibration button and deliver vibration stimulation continuously is 10 seconds. After 10 seconds, the Remote Transmitter will "time-out" for 5 seconds and the button must be released and pressed again. Tone stimulation will be delivered as long as a Tone button is pressed.
What do I do if my dog's neck becomes red and irritated?	This condition is due to the Contact Points irritating the skin. Discontinue use of the Collar Receiver for a few days. If the condition persists beyond 48 hours, see your veterinarian. Once the skin returns to normal, resume use and monitor the skin condition closely.
The Intensity Dial seems difficult to rotate. Is this normal?	Yes. This prevents accidental changes in intensity and encourages an optimal waterproof seal. The knob will "break in" and be slightly easier to turn as you use it.
Can I attach a lead to the Collar Receiver?	DO NOT attach a lead to the Collar Receiver. You may put a separate non-metallic collar on your dog's neck and attach a lead. Be sure the extra collar does not interfere with the Contact Points.
Can I program my SportTrainer® SD-425CAMO-E Remote Trainer to work with my other SportDOG® Brand systems?	Yes. You can program your SD-425CAMO-E Remote Trainer to work with SD-425E, SD-425S-E, SD-825E, SD-1225E, SD-1525E, SD-1825E, or SD-1875E systems. Because the SD-425CAMO-E operates at a different frequency, it is not backwards compatible with any other SportDOG® Brand systems.
My Remote Transmitter is sending a signal to more than one Collar Receiver unintentionally, what should I do?	In the rare event this occurs, you can change your Remote Transmitter's ID Code. See the "Change ID Codes" section to solve this issue.

TROUBLESHOOTING

The answers to these questions should help you solve any problem you have with this system. If they do not, please contact the Customer Care Centre or visit our website at www.sportdog.com.

My dog is not responding when I press a button.

- Check to see if the Collar Receiver has been turned on and the Indicator Light is flashing.
- If your range has reduced from the first time you used it, please check to see if the battery is low in either the Remote Transmitter or Collar Receiver.
- Many factors can impact the range you have with the Remote Trainer. For a list of these factors, please refer to "How the System Works".
- You can verify the Collar Receiver is delivering static stimulation to your dog by placing the Test Light Tool, enclosed in your kit, on the Collar Receiver. Please refer to the "Test Light Tool Instructions" section for details.
- Increase the Intensity Dial. Refer to "Find the Best Intensity Level for Your Dog" for more information.
- Increase the Static Stimulation Range. Refer to "Change Static Stimulation Ranges" for more information.
- Make sure the Collar Receiver's Contact Points are placed snugly against your dog's skin. Refer to "Fit the Collar Receiver" for more information.
- You may need to switch to the longer Contact Points included with your system or trim the hair beneath the Contact Points.
- If you notice your operating time is significantly reduced from the original time, your Collar Receiver battery needs to be replaced. Contact the Customer Care Centre to purchase a new one.

The Collar Receiver will not turn on.

- Make sure the Collar Receiver has been charged. The Collar Receiver will charge in 2 hours.

The Collar Receiver is not responding to the Remote Transmitter.

- Make sure the Remote Transmitter has been charged. The Remote Transmitter will charge in 2 hours.
- Verify the Collar Receiver has been turned on and the Indicator Light is flashing. Refer to "To Turn the Collar Receiver On".
- Refer to "Match the Collar Receiver and Remote Transmitter".

TEST LIGHT TOOL INSTRUCTIONS

1. Turn the Collar Receiver on.
2. Hold the Test Light Tool contacts to the Contact Points.
3. Press a Static Stimulation Button on the Remote Transmitter.
4. The Test Light will flash.
NOTE: At higher Static Stimulation Levels, the Test Light will flash brighter.
5. Turn the Collar Receiver off.

Save the Test Light Tool for future testing.

NOTE: If the Test Light does not flash, recharge the battery and re-test. If the Test Light still does not flash, contact the Customer Care Centre.

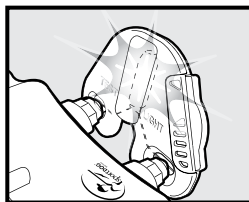

TERMS OF USE AND LIMITATION OF LIABILITY

1. TERMS OF USE

Use of this Product is subject to your acceptance without modification of the terms, conditions and notices contained herein. Use of this Product implies acceptance of all such terms, conditions and notices. If you do not wish to accept these terms, conditions, and notices, please return the Product, unused, in its original packaging and at your own cost and risk to the relevant Customer Care Centre together with proof of purchase for a full refund.

2. PROPER USE

This Product is designed for use with dogs where training is desired. The specific temperament or size/weight of your dog may not be suitable for this Product (please refer to "How the System Works" in this Operating Guide). Radio Systems Corporation recommends that this Product is not used if your dog is aggressive and accepts no liability for determining suitability in individual cases. If you are unsure whether this Product is appropriate for your dog, please consult your veterinarian or certified trainer prior to use. Proper use includes, without limitation, reviewing the entire Operating Guide and any specific safety information statement.

3. NO UNLAWFUL OR PROHIBITED USE

This Product is designed for use with dogs only. This dog training device is not intended to harm, injure or provoke. Using this Product in a way that is not intended could result in violation of Federal, State or local laws.

4. LIMITATION OF LIABILITY

In no event shall Radio Systems Corporation or any of its associated companies be liable for (i) any indirect, punitive, incidental, special or consequential damage and/or (ii) any loss or damages whatsoever arising out of or connected with the misuse of this Product. The Purchaser assumes all risks and liability from the use of this Product to the fullest extent permissible by law.

5. MODIFICATION OF TERMS AND CONDITIONS

Radio Systems Corporation reserves the right to change the terms, conditions and notices governing this Product from time to time. If such changes have been notified to you prior to your use of this Product, they shall be binding on you as if incorporated herein.

COMPLIANCE



This equipment has been tested and found to comply with relevant R&TTE Directives. Before using this equipment outside the EU countries, check with the relevant local R&TTE authority. Unauthorized changes or modifications to the equipment that are not approved by Radio Systems Corporation are in violation of EU R&TTE regulations, could void the user's authority to operate the equipment, and void the warranty.

The Declaration of Conformity can be found at: www.sportdog.com/eu_docs.php.

IC

This device complies with Industry Canada licence-exempt RSS standard(s). Operation is subject to the following two conditions: (1) this device may not cause interference, and (2) this device must accept any interference, including interference that may cause undesired operation of the device.

This device has been designed to operate with the antennas provided with the equipment. Use of other antennas may violate Industry Canada rules and void the user's authority to operate the equipment.

ACMA

This device complies with the applicable EMC requirements specified by the ACMA (Australian Communications and Media Authority).



BATTERY DISPOSAL

⚠ WARNING

See Important Safety Information on page 3 related to the battery.

This system operates on two Li-Ion battery packs (160mAh capacity for the Collar Receiver, 200mAh capacity for the Remote Transmitter). Only replace with battery received from calling the Customer Care Centre. For a listing of the telephone numbers in your area, visit our website at www.sportdog.com.

Separate collection of spent batteries is required in many regions; check the regulations in your area before discarding spent batteries. Please see below for instructions on how to remove the battery from the product for separate disposal.

AT END OF PRODUCT LIFE, USE THESE BATTERY REMOVAL INSTRUCTIONS FOR FINAL DISPOSAL (DO NOT OPEN THE COLLAR RECEIVER OR REMOTE TRANSMITTER UNTIL YOU HAVE RECEIVED THE REPLACEMENT).

- Using a Number 1 Phillips screwdriver, remove the case screws from your Remote Transmitter.
- Using a 3/32 Allen Wrench, remove the case screws from your Collar Receiver.
- Remove the case back or cover.
- Remove the old battery pack.

⚠ WARNING

- When removing the old battery pack, care must be taken when gripping the connector firmly to avoid damaging the wires. Shorting the battery wires may cause fire or explosion.
- These instructions are not valid for repair or battery replacement. Replacing the battery with a battery not specifically approved by Radio Systems Corporation may cause fire or explosion. Please call the Customer Care Centre to avoid invalidating your warranty.



IMPORTANT RECYCLING ADVICE

Please respect the Waste Electrical and Electronic Equipment regulations in your country. This equipment must be recycled. If you no longer require this equipment, do not place it in the normal municipal waste system. Please return it to where it was purchased in order that it can be placed in our recycling system. If this is not possible, please contact the Customer Care Centre for further information. For a listing of Customer Care Centre telephone numbers, visit our website at www.sportdog.com.

WARRANTY

THREE YEAR NON-TRANSFERRABLE LIMITED WARRANTY

This Product has the benefit of a limited manufacturer's warranty. Complete details of the warranty applicable to this Product and its terms can be found at www.sportdog.com and/or are available by contacting your local Customer Care Centre.

Europe - Radio Systems PetSafe Europe Ltd, 2nd Floor, Elgee Building, Market Square, Dundalk, Co. Louth, Ireland

Canada - Radio Systems Corporation, 10427 PetSafe Way, Knoxville, TN 37932 USA

Australia/New Zealand – In compliance with the Australian Consumer Law, Warranties Against Defects, effective January 1, 2012, warranty details of this Product are as follows: Radio Systems Australia Pty Ltd. (hereinafter referred to as "Radio Systems") warrants to the original retail purchaser, and not any other purchaser or subsequent owner, that its Product, when subject to normal and proper residential use, will be free from defects in material or workmanship for a period of three (3) years from the purchase date. An "original retail consumer purchaser" is a person or entity who originally purchases the Product, or a gift recipient of a new Product that is unopened and in its original packaging. When serviced by Radio Systems Customer Service, Radio Systems covers labour and parts for the first three years of ownership; after the first three years, a service or upgrade charge will apply relative to replacement of the Product with new or refurbished items at Radio Systems' sole discretion.

The limited warranty is non-transferrable and shall automatically terminate if the original retail consumer purchaser resells the Radio Systems Product or transfers the property on which the Radio Systems Product is installed. This Limited Warranty excludes accidental damage due to dog chews; lightning damage; or neglect, alteration, and misuse. Consumers who purchase products outside of Australia, New Zealand, or from an unauthorised dealer will need to return the Product to the original place of purchase for any warranty issues.

Please note that Radio Systems does not provide refunds, replacements, or upgrades for change of mind, or for any other reason outside of these Warranty terms.

Claims Procedure: Any claim made under this Warranty should be made directly to Radio Systems Australia Pty Ltd. Customer Care Centre at:

Radio Systems Australia Pty Ltd.
PO Box 7266, Gold Coast Mail Centre QLD 9726, Australia
Australia Residents: 1800 786 608
New Zealand Residents: 0800 543 054
Email: info@petsafeaustralia.com.au

To file a claim, a proof of purchase must be provided. Without a proof of purchase, Radio Systems will not repair or replace faulty components. Radio Systems requests the Consumer to contact the Radio Systems Customer Care Centre to obtain a Warranty Return number, prior to sending the Product. Failure to do so may delay in the repair or replacement of the Product.

If the Product is deemed to be faulty within 30 days from date of original purchase, Radio Systems will organise for a replacement to be sent in advance of returning the faulty Product. A Post Bag will be included with the replacement Product for the return of the faulty Product. The Product must be returned within 7 days of receiving the replacement. If the Product is deemed to be faulty after 30 days from the date of original purchase, the consumer will be required to return the Product to Radio Systems at the consumer's own expense. Radio Systems will test and replace the faulty unit or its components and return to the consumer free of charge, provided the Product is within its said warranty period. This warranty is in addition to other rights and remedies available to you under the law. Radio Systems goods come with guarantees that cannot be excluded under the Australia Consumer Law. You are entitled to a replacement or refund for a major failure and for compensation for any other reasonably foreseeable loss or damage. You are also entitled to have the goods repaired or replaced if the goods fail to be of acceptable quality and the failure does not amount to a major failure.

Should you have any queries or require any further information, please contact our Customer Care Centre on 1800 786 608 (Australia) or 0800 543 054 (New Zealand).



REALTREE MAX-5 Camouflage Pattern © 2013 of Jordan Outdoor Enterprises, Ltd., all rights reserved.



SPORTDOG® ADD-A-DOG™

SPORTDOG.COM

SPORTTRAINER®

COMPATIBLE WITH SD::425CAMO::E



SDR::AFE



SDR::ABE



SD::BEEP::E

©2015 RADIO SYSTEMS CORPORATION
Radio Systems Corporation • 10427 PetSafe Way • Knoxville, TN USA 37932 • 865.777.5404
Radio Systems PetSafe Europe Ltd. • 2nd Floor, Elgee Building, Market Square
Dundalk, Co. Louth, Ireland • +353 (0) 76 892 0427
400-1754/1

