



ADD-A-DOG®

**SDR::AB**

**OPERATING GUIDE**  
PLEASE READ THIS ENTIRE GUIDE BEFORE BEGINNING

# IMPORTANT SAFETY INFORMATION

## Explanation of Attention Words and Symbols used in this guide



This is the safety alert symbol. It is used to alert you to potential personal injury hazards. Obey all safety messages that follow this symbol to avoid possible injury or death.

### **WARNING**

WARNING indicates a hazardous situation which, if not avoided, could result in death or serious injury.

### **CAUTION**

CAUTION, used without the safety alert symbol, indicates a hazardous situation which, if not avoided, could result in harm to your dog.

### **WARNING**

- Not for use with aggressive dogs. Do not use this product if your dog is aggressive, or if your dog is prone to aggressive behavior. Aggressive dogs can cause severe injury and even death to their owner and others. If you are unsure whether this product is appropriate for your dog, please consult your veterinarian or a certified trainer.
- This device contains Lithium-Ion (Li-Ion) batteries; never incinerate, puncture, deform, short-circuit, or charge with an inappropriate charger. Fire, explosion, property damage, or bodily harm may occur if this warning is not followed.
- Risk of explosion if battery is replaced by an incorrect type. Dispose of used batteries according to the instructions.

**CAUTION** Please read and follow the instructions in this manual. Proper fit of the collar is important. A collar worn for too long, or made too tight on the dog's neck may cause skin damage. This is called bed sores; it is also called decubitus ulcers or pressure necrosis.

- Avoid leaving the collar on the dog for more than 12 hours per day.
- When possible, reposition the collar on the dog's neck every 1 to 2 hours.
- Check the fit to prevent excessive pressure; follow the instructions in this manual.
- Never connect a lead to the electronic collar; it will cause excessive pressure on the contacts.
- When using a separate collar for a lead, don't put pressure on the electronic collar.
- Wash the dog's neck area and the contacts of the collar weekly with a damp cloth.
- Examine the contact area daily for signs of a rash or a sore.
- If a rash or sore is found, discontinue use of the collar until the skin has healed.
- If the condition persists beyond 48 hours, see your veterinarian.

For additional information on bed sores and pressure necrosis, please visit the FAQ section for remote trainers at [www.sportdog.com](http://www.sportdog.com).

These steps will help keep your dog safe and comfortable. Millions of dogs are comfortable while they wear stainless steel contacts. Some dogs are sensitive to contact pressure. You may find after some time that your dog is very tolerant of the collar. If so, you may relax some of these precautions. It is important to continue daily checks of the contact area. If redness or sores are found, discontinue use until the skin has fully healed.

- You may need to trim the hair in the area of the contact points or switch to the longer contact points to ensure consistent contact. Never shave the dog's neck; this may lead to a rash or infection.
- You should not make the collar any tighter than is required for good contact. A collar that is too tight will increase the risk of pressure necrosis in the contact area.

Thank you for choosing SportDOG Brand.® Used properly, this product will help you track/train your dog efficiently and safely. To ensure your satisfaction, please review this owner's manual thoroughly. If you have questions regarding this product's operation, contact our Customer Care Center at 1-800-732-0144 or visit our website at [www.sportdog.com](http://www.sportdog.com).

To get the most protection out of your warranty, please register your product within 30 days at [www.sportdog.com](http://www.sportdog.com). By registering, and keeping your receipt you will enjoy the product's full warranty and should you ever need to call the Customer Care Center, we will be able to help you faster. Most importantly, SportDOG™ will never give or sell your valuable information to anyone. Complete warranty information is available online at [www.sportdog.com](http://www.sportdog.com).

## TABLE OF CONTENTS

<b>KEY DEFINITIONS</b> .....	5
<b>PREPARE THE COLLAR RECEIVER</b> .....	6
<b>PREPARE THE REMOTE BEEPER</b> .....	8
<b>FIT THE COLLAR RECEIVER/REMOTE BEEPER</b> .....	9
<b>FIND THE BEST INTENSITY LEVEL FOR YOUR DOG</b> .....	10
<b>CHANGE STIMULATION RANGES</b> .....	11
<b>MATCH THE COLLAR RECEIVER, REMOTE BEEPER AND REMOTE TRANSMITTER</b> .....	12
<b>MANUALLY CONFIGURE REMOTE BEEPER</b> .....	12
<b>CHANGE TONE</b>	
<b>CHANGE RUN MODE</b>	
<b>ACCESSORIES</b> .....	13
<b>TERMS OF USE AND LIMITATION OF LIABILITY</b> .....	14
<b>FCC COMPLIANCE</b> .....	14
<b>BATTERY DISPOSAL</b> .....	15
<b>SPORTDOG™ ADD-A-DOG® RECEIVER/REMOTE BEEPER</b> .....	16

## KEY DEFINITIONS

### COLLAR RECEIVER

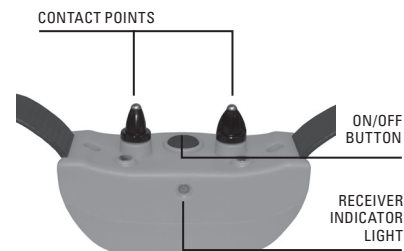

**COLLAR RECEIVER:** Receives the radio signal from the Remote Transmitter and delivers the stimulation, vibration and/or a tone for correcting or cueing your dog. It is waterproof and can be submerged in water to a depth of 25 feet.

**RECEIVER INDICATOR LIGHT:** Indicates when the Collar Receiver has been turned on or off, serves as a low-battery indicator and also indicates when a continuous or momentary (nick) stimulation button is pressed.

**CONTACT POINTS:** The contacts through which the Collar Receiver delivers stimulation.

**ON/OFF BUTTON:** Momentarily pressing and releasing this button turns the Collar Receiver on and off.

### THE COLLAR RECEIVER IS CAPABLE OF DELIVERING FOUR TYPES OF STIMULATION:

**CONTINUOUS:** You control both when and how long stimulation is delivered, up to a maximum of 10 seconds. After 10 seconds, the stimulation will "time out" and the Remote Transmitter button needs to be released and then pressed again before additional stimulation can be delivered.

**MOMENTARY (NICK):** Stimulation is delivered for 1/10 of a second, regardless of how long the button is pressed.

**TONE:** The Collar Receiver will make a rapid beeping noise when a Tone button is pressed, up to a maximum of 10 seconds.

**VIBRATION:** The Collar Receiver will vibrate when a Vibration button is pressed, up to a maximum of 10 seconds.

### REMOTE BEEPER

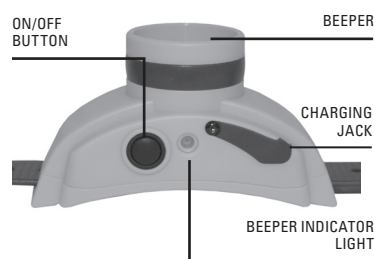

**REMOTE BEEPER:** Receives the radio signal from the Remote Transmitter and beeps with a tone and frequency set by the user. It is waterproof and can be submerged in water to a depth of 25 feet.

**ON/OFF BUTTON:** Turns the beeper on and off. The Remote Beeper's functions can be disabled from the Remote Transmitter, but the Remote Beeper should be turned off using this button when not in use to conserve battery life.

**INDICATOR LIGHT:** Indicates when the Remote Beeper has been turned on or off and also serves as a low-battery indicator.

**BEEPER:** The point at which the sound is produced.

**CHARGING JACK:** For connecting the charger. Although the Remote Beeper is waterproof without it, keep the cover in place when not charging to keep debris out of the opening.



# STEP :: 01

## PREPARE THE COLLAR RECEIVER

### CHARGE THE COLLAR RECEIVER

1. Place Collar Receiver in Charging Cradle as shown.
2. Place the charger connector into the back of the Charging Cradle.
3. Plug the charger into a standard 120/240-volt AC wall outlet.
4. Charge the Collar Receiver for 2 hours for the first charge and every charge thereafter.



Using Li-Ion technology, the Collar Receiver only requires a 2 hour charge. It is not harmful to let the unit charge for more than 2 hours.

*NOTE: Approximate battery life between charges is 40 to 60 hours, depending on frequency of use.*

### CHARGE CRADLE INDICATOR LIGHT

OPERATIONAL MODE	LIGHT COLOR	LIGHT FUNCTION
No Collar Receiver on the Charging Cradle but charger is connected	Green	Light is solid in color
Unit is charging	Red	Light is solid in color while charging
Unit is fully charged (Collar Receiver on Charging Cradle)	Green	Light flashes once per second once the battery is completely charged

### TO TURN THE COLLAR RECEIVER ON

Press and release the On/Off Button. The Receiver Indicator Light comes on and the Collar Receiver will beep 1 to 3 times depending on what stimulation range is chosen. The default is 2 or medium.

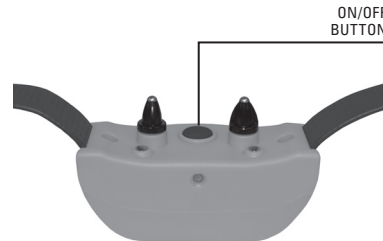

### TO TURN THE COLLAR RECEIVER OFF

Press and release the On/Off Button. The Receiver Indicator Light comes on solid (red) and the Collar Receiver beeps continuously for 2 seconds.

To extend the life between charging cycles, turn the Collar Receiver off when it is not in use.

## RECEIVER INDICATOR LIGHT

OPERATIONAL MODE	LIGHT COLOR	LIGHT FUNCTION	BATTERY STATUS	SPEAKER FUNCTION	VIBRATION
Unit is turned on via On/Off Button	Green	Light is solid in color during beep sequence	Good	Beeps 1-3 times depending on stimulation range setting (2 is the default setting). See page 11.	N/A
Unit is turned on via On/Off Button	Red	Light is solid in color during beep sequence	Low		N/A
Unit is turned off via On/Off Button	Red	Light is solid in color during beep sequence	N/A	Beeps continuously for 2 seconds	N/A
Unit is on	Green	Light flashes every 3 seconds	Good	N/A	N/A
Unit is on	Red	Light flashes every 3 seconds	Low	N/A	N/A
Unit is delivering continuous stimulation	Red	Light is solid in color for as long as button is pressed	N/A	N/A	N/A
Unit is delivering momentary stimulation	Red	Light will quickly flash once no matter how long button is pressed	N/A	N/A	N/A
Unit is delivering tone	Off	N/A	N/A	Unit will beep for as long as button is pressed	N/A
Unit is delivering vibration	Off	N/A	N/A	N/A	Unit will vibrate for as long as button is pressed

### RECHARGEABLE BATTERIES

#### ⚠ WARNING

- This device contains Lithium-Ion (Li-Ion) batteries; never incinerate, puncture, deform, short-circuit, or charge with an inappropriate charger. Fire, explosion, property damage, or bodily harm may occur if this warning is not followed.
- Risk of explosion if battery is replaced by an incorrect type. Dispose of used batteries according to the instructions (see page 15).
- Batteries should never be removed from the battery compartment for charging.
- Risk of explosion if batteries are charged in areas with high temperature (100° F+).
- The rechargeable Lithium Ion (Li-Ion) batteries are not memory sensitive, do not require depletion before charging and cannot be over charged.
- The batteries come partially charged from the factory, but will require a full charge before the first use.

- When storing the unit for long periods, remember to regularly give batteries a full charge. This should be done once every 3 to 4 months.
- You should expect hundreds of recharge cycles from your batteries. However, all rechargeable batteries lose capacity over time relative to the number of recharge cycles they experience. This is normal. If your operating time drops to half of the original life, contact the Customer Care Center to purchase a new battery.
- The batteries should last for a period of 3-5 years. When a battery needs replacement, you can order a new pack by calling our Customer Care Center at 1-800-732-0144. Please do not open the Collar Receiver or Remote Beeper until you have received the replacement.

## STEP :: 02

### PREPARE THE REMOTE BEEPER

#### CHARGE THE REMOTE BEEPER

1. Lift the rubber cover protecting the Charging Jack.
2. Connect accessory cable to cradle and Remote Beeper.
3. Plug the charger into a standard 120/240-volt AC wall outlet.
4. Charge the Remote Beeper for 2 hours for the first charge and every charge thereafter.



Using Li-Ion technology, the Remote Beeper only requires a 2 hour charge. It is not harmful to let the unit charge for more than 2 hours.

5. When charging is complete, replace the rubber cover.

*NOTE: Approximate battery life between charges is 60-80 hours, depending on frequency of use.*

#### TURN THE REMOTE BEEPER ON

Press and release the On/Off Button. The Remote Beeper Indicator Light will come on and the Remote Beeper will beep 1 time.

#### TURN THE REMOTE BEEPER OFF

Press and release the On/Off Button. The Remote Beeper Indicator Light will come on solid (red) and the Remote Beeper will beep for 1 second.

### REMOTE BEEPER INDICATOR LIGHT

REMOTE BEEPER FUNCTION	LIGHT COLOR	LIGHT FUNCTION	BATTERY STATUS
Unit is on	Green	Light flashes every 3 seconds	Good
Unit is on	Red	Light flashes every 3 seconds	Low
Unit is turned on via On/Off Button	Green	Light is solid in color during beep sequence	N/A
Unit is turned off via On/Off Button	Red	Light is solid in color during beep sequence	N/A
Unit is charging	Green	Light is solid in color	N/A
Unit is fully charged	Green	Light flashes every second	N/A

## STEP :: 03

### FIT THE COLLAR RECEIVER/REMOTE BEEPER

**IMPORTANT:** The proper fit and placement of the Collar Receiver is important for effective training. The Contact Points must have direct contact with your dog's skin.

**CAUTION** Please read and follow the instructions in this manual. Proper fit of the collar is important. A collar worn for too long, or made too tight on the dog's neck may cause skin damage. This is called bed sores; it is also called decubitus ulcers or pressure necrosis.

- Avoid leaving the collar on the dog for more than 12 hours per day.
- When possible reposition the collar on the dog's neck every 1 to 2 hours.
- Check the fit to prevent excessive pressure; follow the instructions in this manual.
- Never connect a lead to the electronic collar; it will cause excessive pressure on the contacts.
- When using a separate collar for a lead, don't put pressure on the electronic collar.
- Wash the dog's neck area and the contacts of the collar weekly with a damp cloth.
- Examine the contact area daily for signs of a rash or a sore.
- If a rash or sore is found, discontinue use of the collar until the skin has healed.
- If the condition persists beyond 48 hours, see your veterinarian.

For additional information on bed sores and pressure necrosis, please visit the FAQ section for remote trainers at [www.sportdog.com](http://www.sportdog.com).

These steps will help keep your dog safe and comfortable. Millions of dogs are comfortable while they wear stainless steel contacts. Some dogs are sensitive to contact pressure. You may find after some time that your dog is very tolerant of the collar. If so, you may relax some of these precautions. It is important to continue daily checks of the contact area. If redness or sores are found, discontinue use until the skin has fully healed.

This system is designed so you can add or remove the Remote Beeper to or from the Collar Receiver strap as needed. The Remote Beeper can also be used on the collar strap without the Collar Receiver.

To ensure a proper fit, follow these steps:

1. Thread the end of the collar strap through the slot in the Remote Beeper and then through the slot on the opposite side of the Remote Beeper. Slide the Remote Beeper a few more inches up the collar strap. The knob located on the bottom of the Remote Beeper can be placed in one of the collar strap holes to prevent sliding and to ensure it remains in place properly.
2. With your dog standing (3A), center the Collar Receiver so the Contact Points are underneath your dog's neck, touching the skin (3B) and the Remote Beeper is centered behind the dog's head. If your dog has a long or thick coat, you have two options to ensure consistent contact: either trim the hair around the Contact Points or switch to the longer Contact Points included with your system.

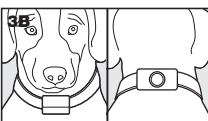
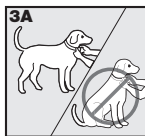

#### CAUTION

- You may need to trim the hair in the area of the Contact Points. Never shave the dog's neck; this may lead to a rash or infection.
- You should not make the collar any tighter than is required for good contact. A collar that is too tight will increase the risk of pressure necrosis in the contact area.

3. The Collar Receiver should fit snugly, yet loose enough to allow one finger to fit between the strap and your dog's neck (3C).
4. Allow your dog to wear the collar for several minutes, and then recheck the fit. Check the fit again as your dog becomes more comfortable wearing the Collar Receiver/Remote Beeper.

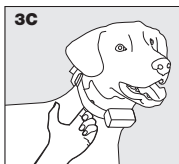

## FIND THE BEST INTENSITY LEVEL FOR YOUR DOG

SportDOG Brand® systems have multiple intensity levels. This allows you to choose the stimulation that is best for your dog.

*NOTE: Always start at the lowest level and work your way up.*

For training efficiency, it is important to find the right intensity level for your dog. This is called the Recognition Level, at which your dog looks around in curiosity, or flicks his ears.

### FINDING YOUR DOG'S RECOGNITION LEVEL

*NOTE: Every dog is different and you cannot predict where your dog's Recognition Level will be. Watch closely for any slight change in behavior that tells you your dog is feeling the stimulation.*

1. With the Collar Receiver turned on and properly fitted to your dog, set the Remote Transmitter's Intensity Dial at Level 1 and press the Continuous Stimulation Button for 1 to 2 seconds.
2. If your dog shows no reaction to Level 1, go to Level 2 and repeat the process.

3. YOUR DOG SHOULD NOT VOCALIZE OR PANIC WHEN RECEIVING STIMULATION. IF THIS HAPPENS, THE STIMULATION LEVEL IS TOO HIGH AND YOU NEED TO GO BACK TO THE PREVIOUS LEVEL AND REPEAT THE PROCESS.
4. Once you find your dog's Recognition Level, this is the level you should use when you begin a training exercise.
5. If you have progressed to the maximum level while searching for your dog's Recognition Level and your dog continues to show no response, check to see if Collar Receiver is snug against your dog's neck. Then go back to Intensity Level 1 and repeat the process. If your dog still does not indicate he is feeling the stimulation, you have three options: you may have to trim the hair beneath the Contact Points, switch to the longer Contact Points included in your system or change the stimulation range (see below).

If after completing all of these steps your dog still does not indicate he is feeling the stimulation, please contact Customer Care Center at 1-800-732-0144.

## STEP :: 04

### CHANGE STIMULATION RANGES

The UplandHunter® 1875 Collar Receiver comes with 3 stimulation ranges (low, medium and high). There are 7 stimulation levels within each range, with 1 being the lowest and 7 being the highest. The default range setting is 2 or medium.

To change the range of stimulation, follow these steps:

1. Make sure the Collar Receiver is off.
2. Then turn the unit on by pressing and releasing the on/off button.
3. After the Indicator Light turns off and within 5 seconds, press and hold the on/off button for 3 seconds.
4. The Collar Receiver will then beep once and the Indicator Light will flash orange. This indicates **Low** stimulation range. If **Medium** or **High** are desired, continue to hold the button until the number of beeps/orange flashes equals the desired stimulation range shown in the chart below.
5. Release the button once the desired range is selected; the Collar Receiver will turn off.
6. Turn the unit back on. It will then beep according to the stimulation range selected in step 4.

	STIMULATION RANGE	DOG TEMPERAMENT
1 beep	Low	Mild
2 beeps	Medium	Moderate
3 beeps	High	Stubborn

# STEP :: 05

## MATCH THE COLLAR RECEIVER, REMOTE BEEPER AND REMOTE TRANSMITTER

To match the Collar Receiver/Remote Beeper to work with a new Remote Transmitter or to reprogram a new Collar Receiver/Remote Beeper to work with your existing Remote Transmitter (SD-1875, SD-1825, SD-1825CAMO, SD-2525):

- A. Check to make sure the Collar Receiver/Remote Beeper are off.
- B. Press and hold the On/Off Button for each. The Collar Receiver/Remote Beeper Indicator Lights will come on, then turn off after 4-5 seconds. If the On/Off Button is released too early, the Collar Receiver/Remote Beeper Indicator Lights will begin flashing as normal. If this occurs, start over from **A**.
- C. After the Collar Receiver/Remote Beeper Indicator Lights have turned off, release the On/Off Button.
- D. Press and hold the Upper Button on the Remote Transmitter until the Collar Receiver/Remote Beeper Indicator Lights flash 5 times. Once the Collar Receiver/Remote Beeper Indicator Lights have flashed 5 times, the Collar Receiver/Remote Beeper have been matched and will begin flashing as normal. If the Collar Receiver/Remote Beeper Indicator Lights do not flash 5 times, start over from **A**.

*NOTE: For more information on programming modes or adding an additional dog(s), please consult the original Operating Guide that came with your SD-1875, SD-1825, SD-1825CAMO or SD-2525 system; or visit our website to download a manual at [www.sportdog.com](http://www.sportdog.com).*

# STEP :: 06

## MANUALLY CONFIGURE REMOTE BEEPER

While the Remote Beeper can be remotely programmed from the UplandHunter® 1875 Remote Transmitter (see SD-1875 Operating Guide), you can also set tone and run mode from the beeper itself.

1. Turn the Remote Beeper off.
2. Press and release the On/Off button to turn on the Remote Beeper.
3. Within 5 seconds press and hold the On/Off button. The Remote Beeper will begin to cycle through available tones.
4. When the desired tone is heard, release the button before the next tone starts. Tone is now set.
5. Press and hold the button immediately following tone selection completion until the number of beeps matches the desired run mode as shown in the chart below.

1 Beep (Silent)	No beep when dog is running/Beeps once per second when dog is on point
2 Beeps (5 second)	Beeps every 5 seconds when dog is running/Beeps once per second when dog is on point
3 Beeps (10 second)	Beeps every 10 seconds when dog is running/Beeps once per second when dog is on point

6. Release the button after the corresponding number of beeps matches your desired run mode.

## LOCATING YOUR DOG IN THE FIELD

Anytime your dog is within one mile, you can make the Remote Beeper beep by pressing the Locate Button on the Remote Transmitter. The Remote Beeper will beep once each time you press the button. Pressing the Locate Button disables the Remote Beeper's run mode, but it is still on. To reactivate the run mode, press and release the UplandHunter® 1875 Remote Transmitter's Run Mode button. To reactivate the run mode on SD-1825, SD-1825CAMO or SD-2525 models, press and hold the Remote Transmitter's Locate Button. The Remote Beeper will emit 3 beeps to confirm run mode has been activated and will continue operating in the last run mode in which it was set.

## ACCESSORIES

To purchase additional accessories for your SportDOG Brand® UplandHunter® Add-A-Dog®, contact the Customer Care Center at 1-800-732-0144 or visit our website at [www.sportdog.com](http://www.sportdog.com) to locate a retailer near you.

Component	Part Number
¾" Grey Collar Strap	SAC00-13864
¾" Blaze Orange Collar Strap	SAC00-10815
¾" Black Collar Strap	SAC00-10816
Remote Beeper (does not include collar strap)	SDT00-13820
Collar Receiver (does not include collar strap)	SDT00-13821
SD-1875 Charging Cradle	SAC00-13862
Adaptor	SDT00-12272
Charging Cable (Remote Beeper)	SAC00-13822
Contact Points (Short)	SAC00-12571
Contact Points (Long)	SAC00-12570
Battery Kit (Collar Receiver)	SAC00-12544
Battery Kit (Remote Beeper)	SAC00-13794
SD-1875 Accessory Kit (includes belt clip, lanyard, power plug covers for Remote Transmitter and Remote Beeper, rubber band for Remote Beeper)	SAC00-13823

## TERMS OF USE AND LIMITATION OF LIABILITY

### 1. TERMS OF USE

This Product is offered to you conditioned upon your acceptance without modification of the terms, conditions and notices contained herein. Usage of this Product implies acceptance of all such terms, conditions, and notices.

### 2. PROPER USE

This Product is designed for use with dogs where tracking/training is desired. The specific temperament of your dog may not work with this Product. We recommend that you not use this Product if your dog is less than 8 pounds or if your dog is aggressive. If you are unsure whether this is appropriate for your dog, please consult your veterinarian, certified trainer or contact our Customer Care Center at 1-800-732-0144.

Proper use includes reviewing the entire Operating Guide provided with your Product and any specific Caution statements.

### 3. NO UNLAWFUL OR PROHIBITED USE

This Product is designed for use with dogs only. This dog training device is not intended to harm, injure, or provoke. Using this Product in a way that is not intended could result in violation of Federal, State or local laws.

### 4. LIMITATION OF LIABILITY

In no event shall Radio Systems® Corporation be liable for any direct, indirect, punitive, incidental, special or consequential damages, or any damages whatsoever arising out of or connected with the use or misuse of this Product. Buyer assumes all risks and liability from the use of this Product.

### 5. MODIFICATION OF TERMS AND CONDITIONS

Radio Systems Corporation reserves the right to change the terms, conditions and notices under which this Product is offered.

## FCC COMPLIANCE

This device complies with part 15 of the FCC Rules. Operation is subject to the following two conditions: (1) This device may not cause harmful interference, and (2) this device must accept any interference received, including interference that may cause undesired operation.

This equipment has been tested and found to comply with the limits for a Class B digital device, pursuant to part 15 of the FCC Rules. These limits are designed to provide reasonable protection against harmful interference in a residential installation. This equipment generates, uses and can radiate radio frequency energy and, if not installed and used in accordance with the instructions, may cause harmful interference to radio communications. However, there is no guarantee that interference will not occur in a specific installation. If interference does occur to radio or television reception, which can be determined by turning the equipment off and on, the user is encouraged to try to correct the interference by one or more of the following measures:

- Reorient or relocate the receiving antenna.
- Increase the separation between the equipment and the receiver.
- Connect the equipment to an outlet on a circuit different from that to which the receiver is connected.
- Contact customer service or an experienced radio/TV technician for assistance.

Caution: Unauthorized changes or modifications to the equipment may violate FCC regulations and could void the user's authority to operate the equipment.

## IC - CANADA

This device complies with Industry Canada licence-exempt RSS standard(s). Operation is subject to the following two conditions: (1) this device may not cause interference, and (2) this device must accept any interference, including interference that may cause undesired operation of the device.

Le présent appareil est conforme aux CNR d'Industrie Canada applicables aux appareils radio exempts de licence. L'exploitation est autorisée aux deux conditions suivantes : (1) l'appareil ne doit pas produire de brouillage, et (2) l'utilisateur de l'appareil doit accepter tout brouillage radioélectrique subi, même si le brouillage est susceptible d'en compromettre le fonctionnement.

**Customer Care Center / Service clientèle**  
800-732-2677

Monday - Friday / Lundi - Vendredi  
8 am - 8 pm / 8h00 - 20h00  
Saturday / Samedi  
9 am - 5 pm / 9h00 - 17h00

## BATTERY DISPOSAL

**WARNING** See important safety information on page 2 related to the battery.

This system operates on two Li-Ion battery packs (240mAh capacity for the Collar Receiver and 400mAh for the Remote Beeper). Only replace with battery received from calling the Customer Care Center at 1-800-732-0144.

Separate collection of spent batteries is required in many regions; check the regulations in your area before discarding spent batteries. Please see below for instructions on how to remove the battery from the product for separate disposal. If you wish to ship us your spent batteries for disposal, contact the Customer Care Center.

**AT END OF PRODUCT LIFE, USE THESE BATTERY REMOVAL INSTRUCTIONS FOR FINAL DISPOSAL (DO NOT OPEN THE COLLAR RECEIVER OR REMOTE BEEPER UNTIL YOU HAVE RECEIVED THE REPLACEMENT):**

- Using a #1 Phillips screwdriver for your Remote Beeper and/or a 3/32 Allen wrench for your Collar Receiver, remove the case screws.
- Remove the case back or cover.
- Remove the old battery pack. *NOTE: When removing the old battery pack, care must be taken when gripping the connector firmly to avoid damaging the wires. Shorting the battery wires may cause fire or explosion.*

*NOTE: These instructions are not valid for repair or battery replacement. Replacing the battery with a battery not specifically approved by Radio Systems® Corporation may cause fire or explosion. Please call the Customer Care Center at 1-800-732-0144 to avoid invalidating your warranty.*

This product is protected by the following patents:  
U.S. Patent Numbers: 7,017,524; 7,420,136; 6,184,790; 6,459,378; 7,647,545  
For use under U.S. Patent No. 7,814,865





[SPORTDOG.COM](http://SPORTDOG.COM)

**SPORTDOG / ADD-A-DOG®**  
*Collar Receiver/Remote Beeper*



**UPLANDHUNTER®**  
SDR::AB ADD-A-DOG®



**UPLANDHUNTER®**  
SD::BEEP REMOTE BEEPER

NOTE: SDR-FS, SDR-FH, SDR, SDR-CH, SDR-FC, SDR-BEEP AND SDR-H ADD-A-DOG COLLARS ARE NOT COMPATIBLE WITH THIS SYSTEM.  
SDR-A, SDR-AW AND SDR-AH ADD-A-DOG COLLARS ARE COMPATIBLE WITH THIS SYSTEM.

©2012 RADIO SYSTEMS CORPORATION  
Radio Systems® Corporation • 10427 PetSafe Way • Knoxville, TN 37932 • 1-800-732-0144  
J400-1586